

Using this chart:

Starting at the left-hand side, follow the decision tree to find step-by-step guidance for using Panopto. Select an icon below a step to open a webpage giving detailed guidance for that step. Visit celt.southwales.ac.uk/tel or contact your faculty TEL partner if you have any questions.

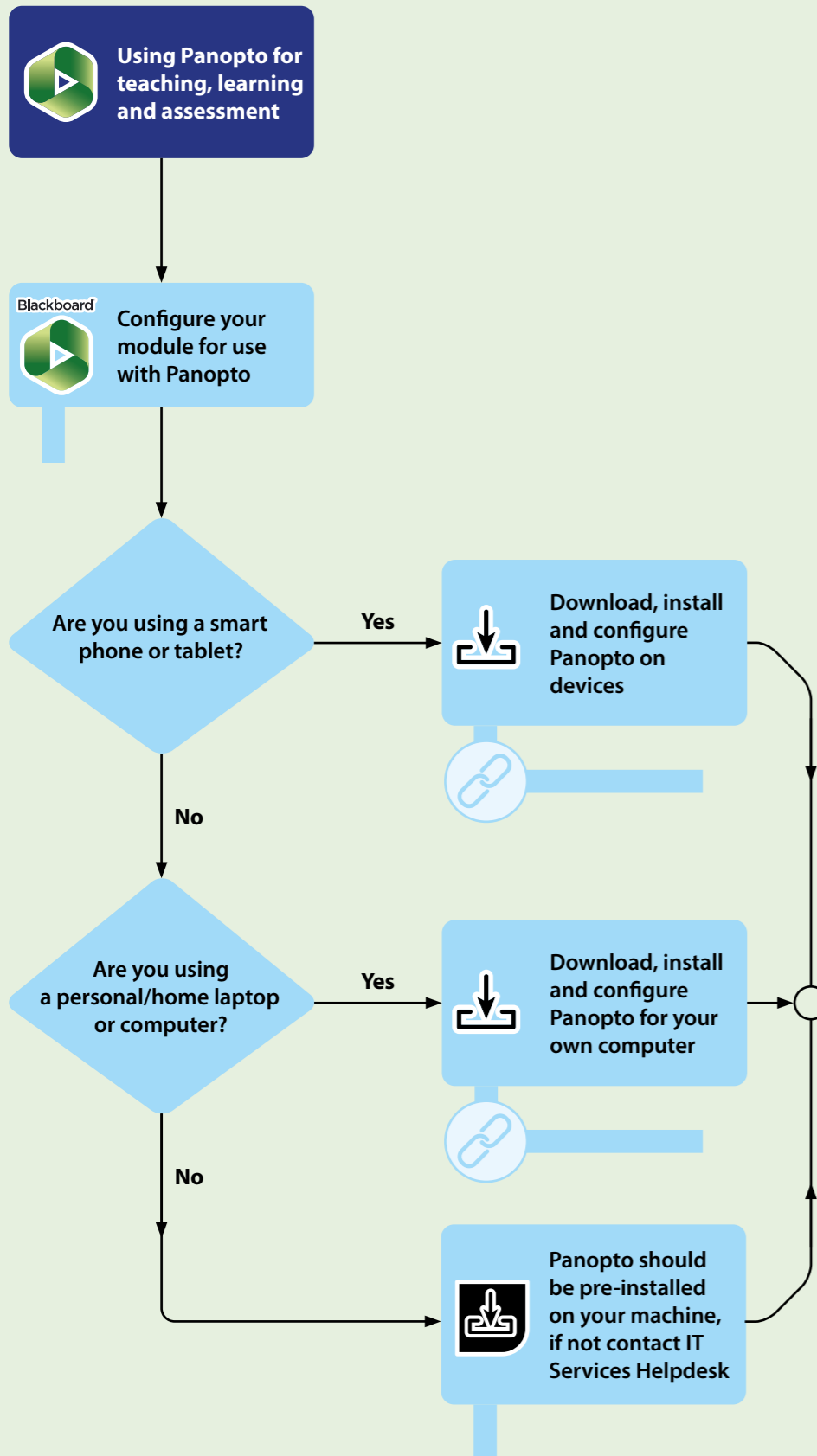

Setting-up Panopto...



What you can do...

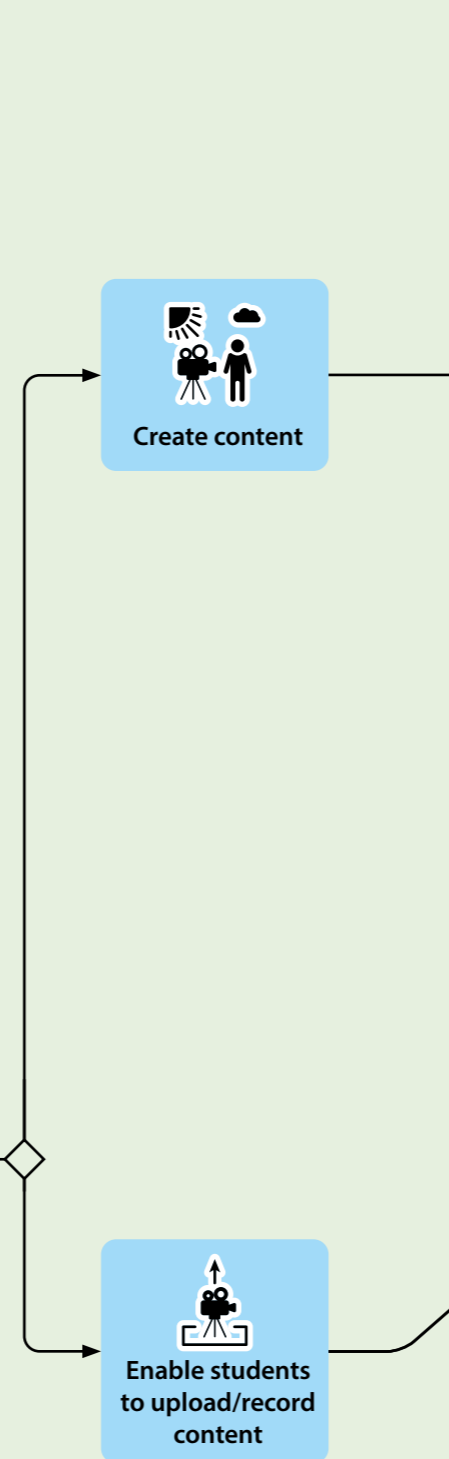

How you do this...

